

DRAWING NO. **30-740M**

DATE	SYM	REVISION	DR

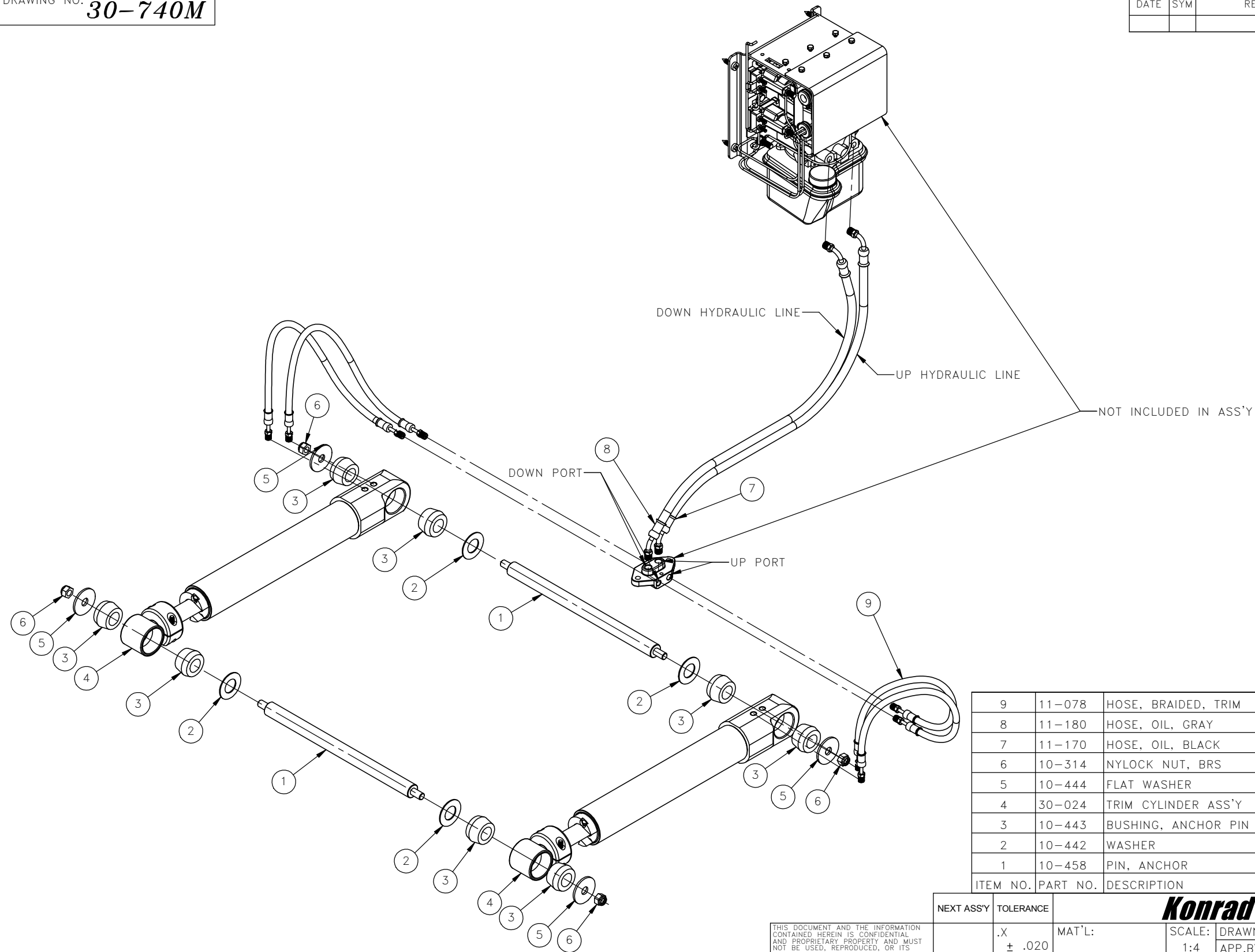

**TRIM ASS'Y
600 / 700 SERIES**

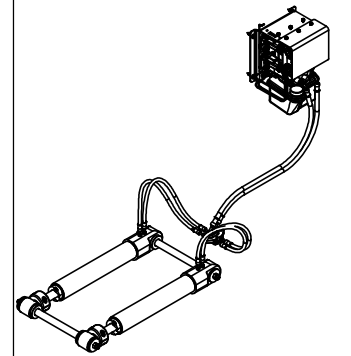

ITEM NO.	PART NO.	DESCRIPTION	QTY.
9	11-078	HOSE, BRAIDED, TRIM	4
8	11-180	HOSE, OIL, GRAY	1
7	11-170	HOSE, OIL, BLACK	1
6	10-314	NYLOCK NUT, BRS	4
5	10-444	FLAT WASHER	4
4	30-024	TRIM CYLINDER ASS'Y	2
3	10-443	BUSHING, ANCHOR PIN	8
2	10-442	WASHER	4
1	10-458	PIN, ANCHOR	2

<small>THIS DOCUMENT AND THE INFORMATION CONTAINED HEREIN IS CONFIDENTIAL AND PROPRIETARY PROPERTY AND MUST NOT BE USED, REPRODUCED, OR ITS CONTENT DISCLOSED, IN WHOLE OR IN PART, WITHOUT PRIOR WRITTEN CONSENT OF KONRAD MARINE. (C) COPYRIGHT 2004 KONRAD MARINE ALL RIGHTS RESERVED DO NOT SCALE DRAWING</small>	NEXT ASSY	Konrad	
	TOLERANCE	MAT'L:	SCALE: DRAWN BY: SC
	.X ± .020	1:4	APP.BY:
	.XX ± .010	TITLE: TRIM ASS'Y, 600/700 SERIES	
WEIGHT: 30.00 LBS.	.XXX ± .005	DATE: 11/12/13	DRAWING NUMBER 30-740M