

DRAWING NO. **30-044M**

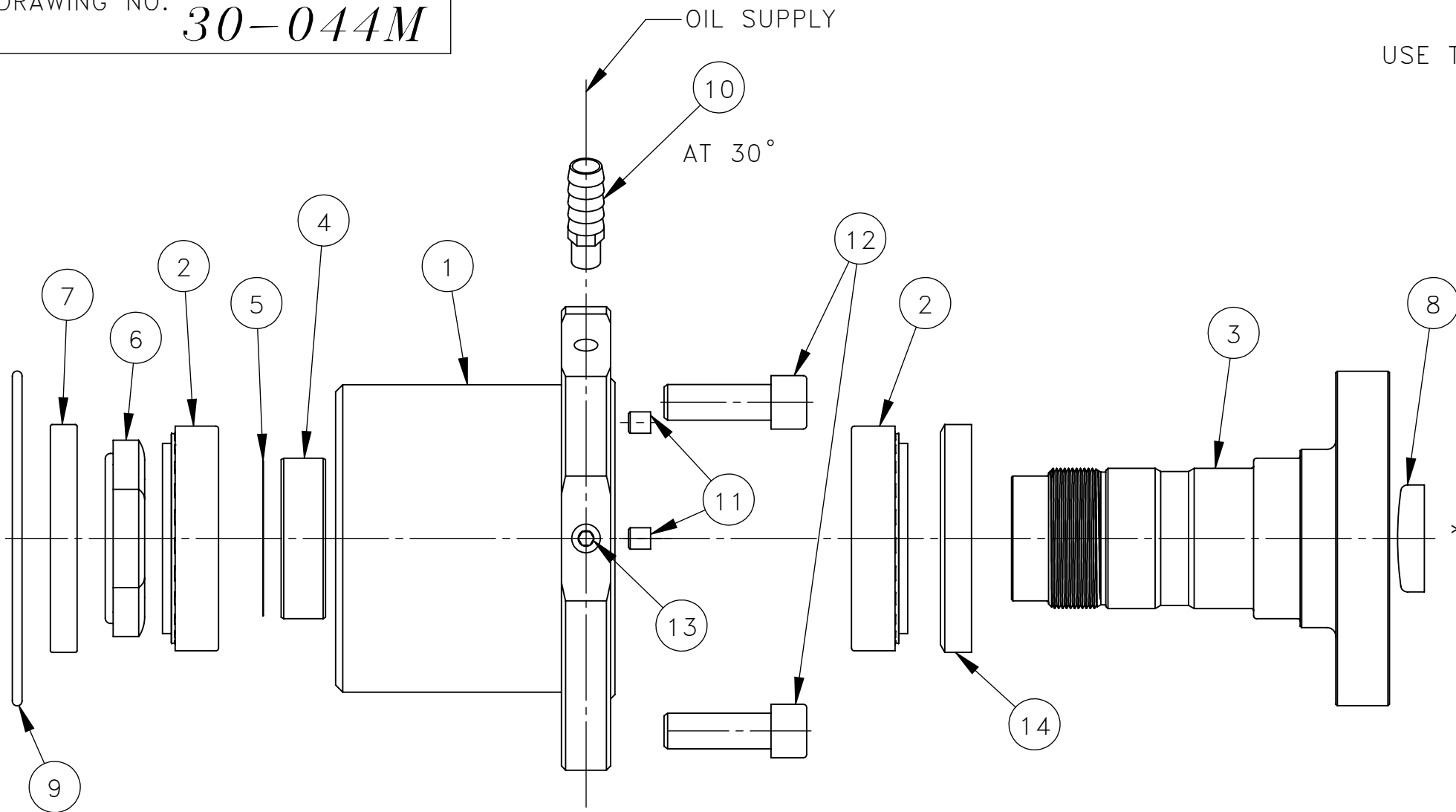

USE THIS ASSEMBLY FOR DRIVE SHAFT INSTALLATIONS

THIS IS A STANDARD 520/540 GIMBAL CARRIER ASSEMBLY. IF YOURS IS A CUSTOM ASSEMBLY PLEASE CONTACT FACTORY TO VERIFY CORRECT COMPONENTS.

14	10-472	SEAL	1
13	10-396	PLUG SHSS	2
12	10-385	S.H.C.S.	3
11	10-469	BRASS PLUG	3
10	10-470	NIPPLE	1
9	10-383	O-RING	1
8	10-485	PLUG, EXPANSION	1
7	10-473	SEAL	1
6	10-389	LOCKNUT	1
5	10-568	KIT, SHIM	1
4	10-558	SPACER	1
3	10-629	FLANGE, GIMBLE, ROUND, 500/600A	1
2	10-471	BEARING	2
1	10-467	CARRIER, GIMBAL	1
ITEM NO.	PART NO.	DESCRIPTION	QTY.

NOW #13-823

* NOTES:

- ITEM #14-ORIGINAL GIMBAL CARRIERS WITHIN TRANSON ASSEMBLIES PRIOR TO 7/28/04 OR BEFORE A TRANSON ASSEMBLY SERIAL #3084 WILL USE SEAL #10-472. ALL OTHER GIMBAL CARRIER ASSEMBLIES SHOULD USE SEAL #11-612.
- ITEM #3-IF GIMBAL FLANGE IS REPLACED ON ORIGINAL GIMBAL CARRIERS WITHIN TRANSON ASSEMBLIES PRIOR TO 7/28/04 OR BEFORE A TRANSON ASSEMBLY SERIAL #3084 SHOULD USE SEAL #11-612.

THIS DOCUMENT AND THE INFORMATION CONTAINED HEREIN IS CONFIDENTIAL AND PROPRIETARY PROPERTY AND MUST NOT BE USED, REPRODUCED, OR ITS CONTENT DISCLOSED, IN WHOLE OR IN PART, WITHOUT PRIOR WRITTEN CONSENT OF KONRAD MARINE.
DO NOT SCALE DRAWING

WEIGHT: 11.856 LBS.

NEXT ASS'Y	TOLERANCE	Konrad	
	.X ± .020	MAT'L:	SCALE: 1:2 DRAWN BY: SC
	.XX ± .010	TITLE: ASS'Y, GIMBAL CARRIER, 520/540, 4 BOLT FLANGE	
	.XXX ± .005	DATE: 2/7/23	DRAWING NUMBER 30-044M